



ARG
Royal Ensign
Premium Luxury Apartments

get yourself invited to a high life

Facilities



- 24 hrs Security managed by well trained security staff.
- Gas bank with piping to each flat.
- Parking (Open / Stilt & Basement).
- Guest Car Parking facility.
- Huge Lush Green Landscaped areas.
- Earth quake resistant structure.
- Rain water harvesting.
- Vastu Friendly Layout.
- Kitchen Garbage disposal facility.
- Well ventilated Rooms.
- Commercial Area for Daily needs and Groceries.
- Out door play area for kid's.
- Jogging Track.
- Drivers dormitory
- Car clean Area.
- Two Elevators in each Block
- Power back up for common light and Elevators.
- Well designed entrance Lobby.
- Temple.
- Walking distance from Alwar Railway Station.
- Very close to main Market.
- Ultra Modern Club House :
 - Badminton Court.
 - Swimming Pool (along with Kid's Pool).
 - Party Hall.
 - Modern Gym.
 - Table Tennis.
 - Billiards.
 - Carrom / Chess.
 - Home Theater.

Home in, and
be a part of this royal
league for life. Let your
children inherit your
heritage.



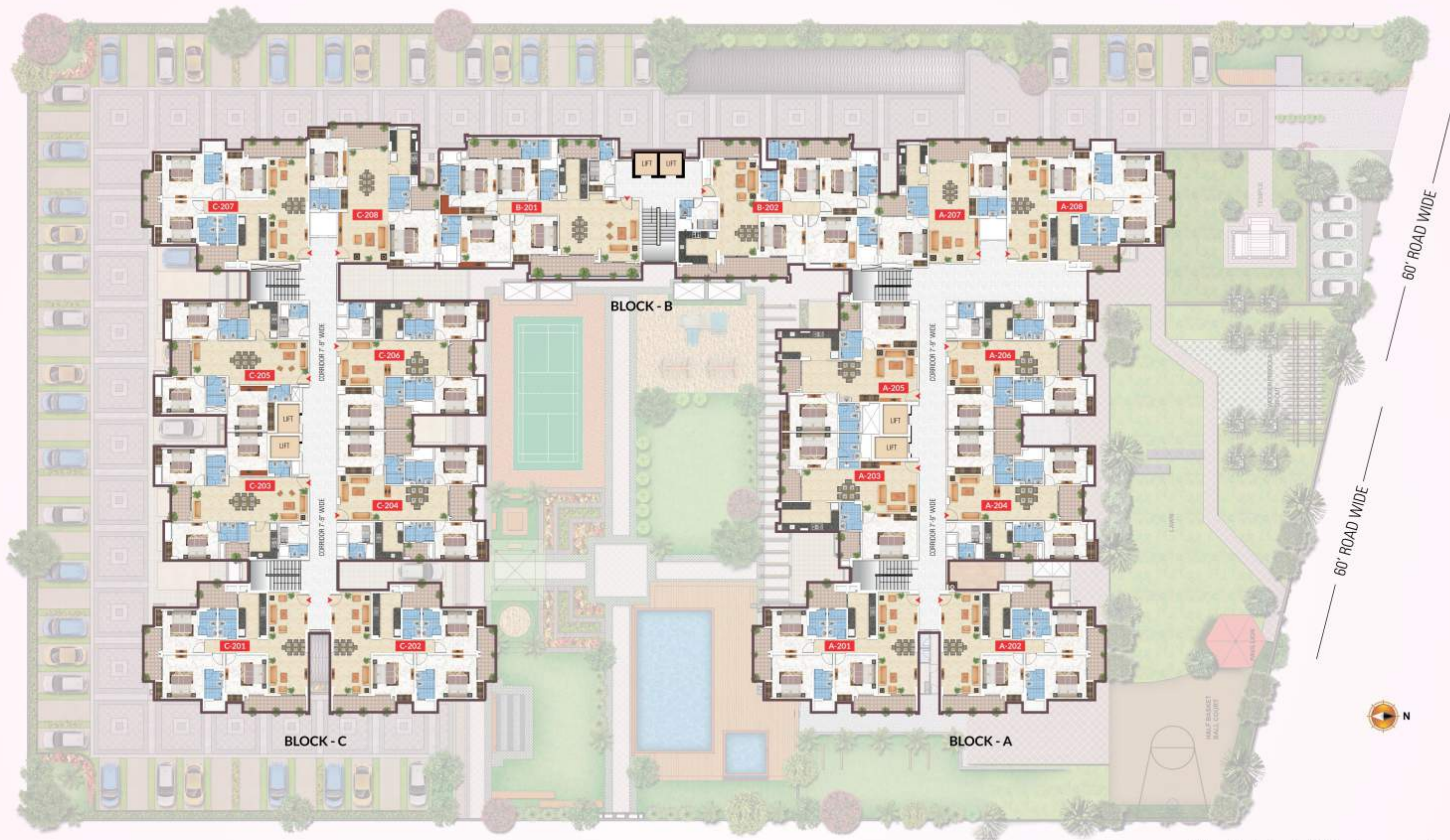

*Please Contact us for 1st floor plan area chart.

2nd Floor to 9th Floor Plan



| Block C | | | |
|---------|----------|-------|----------------|
| Type | Flat No. | BHK | Saleable Area |
| Type 3 | 208 | 2 BHK | 1409.06 sq.ft. |
| Type 3 | 204 | 3 BHK | 1661.39 sq.ft. |
| Type 4 | 206 | 3 BHK | 1689.25 sq.ft. |
| Type 5 | 203 | 3 BHK | 1604.01 sq.ft. |
| Type 6 | 205 | 3 BHK | 1639.88 sq.ft. |
| Type 7 | 201 | 3 BHK | 1823.71 sq.ft. |
| Type 7 | 202 | 3 BHK | 1806.60 sq.ft. |
| Type 8 | 207 | 3 BHK | 1818.80 sq.ft. |

*Built up Area 20% less

| Block B | | | |
|---------|----------|-------|----------------|
| Type | Flat No. | BHK | Saleable Area |
| Type 1 | 201 | 4 BHK | 2446.83 sq.ft. |
| Type 2 | 202 | 4 BHK | 2422.29 sq.ft. |

*Built up Area 20% less

| Block A | | | |
|---------|----------|-------|----------------|
| Type | Flat No. | BHK | Saleable Area |
| Type 1 | 203 | 2 BHK | 1303.26 sq.ft. |
| Type 2 | 205 | 2 BHK | 1309.23 sq.ft. |
| Type 3 | 207 | 2 BHK | 1398.95 sq.ft. |
| Type 1 | 204 | 3 BHK | 1685.05 sq.ft. |
| Type 2 | 206 | 3 BHK | 1703.75 sq.ft. |
| Type 7 | 201 | 3 BHK | 1822.28 sq.ft. |
| Type 7 | 202 | 3 BHK | 1807.56 sq.ft. |
| Type 8 | 208 | 3 BHK | 1812.26 sq.ft. |

*Built up Area 20% less



STILT FLOOR PLAN

Legend

- | | | | | |
|---|----------------------|--------------------------|---------------------|----------------------------|
| 1. Main Entry | 6. Multi Play System | 12. Card Room | 18. Gymnasium | 24. Steam Room |
| 2. Security | 7. Kid's Play Area | 13. Wide Raised Platform | 19. Lobby | 25. Garden |
| 3. Temple | 8. Badminton Court | 14. Pantry | 20. Kid's Pool | 26. Parking |
| 4. Ramp Down from Stilt to Basement floor | 9. Table Tennis Room | 15. Store | 21. Swimming Pool | 27. Pavillion |
| 5. Stair Lobby | 10. Reception Area | 16. Home Theater | 22. Meditation Lawn | 28. Half Basket Ball Court |
| | 11. Billiards Room | 17. Party Hall | 23. Sand Pit | 29. Wooden Pergola Sit-Out |

Type -1 (2 BHK)

S.B.U.A. 1303.26 Sq.ft.
to 1309.23 Sq.ft.

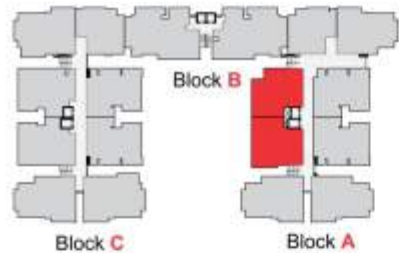

* Built up area is 20% less than Super Built up area.

Type -1 (3 BHK)

S.B.U.A. 1661.39 sq.ft.
to 1703.75 sq.ft.

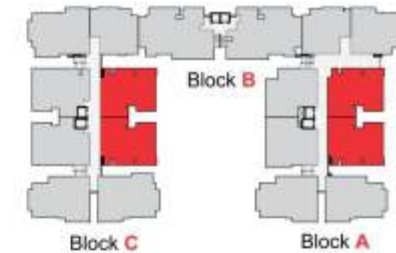

* Built up area is 20% less than Super Built up area.

Type -2 (2 BHK)

S.B.U.A. 1398.95 sq.ft.
to 1409.06 sq.ft.



* Built up area is 20% less than Super Built up area.

Type -2 (3 BHK)

S.B.U.A. 1604.01 sq.ft.
to 1639.88 sq.ft.

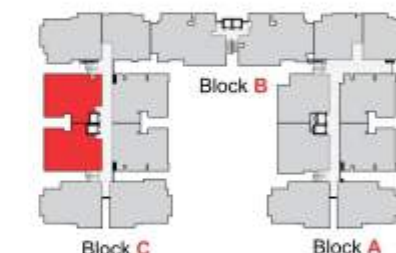

* Built up area is 20% less than Super Built up area.

Type -3 (3 BHK)

S.B.U.A. 1806.60 sq.ft.
to 1823.71 sq.ft.

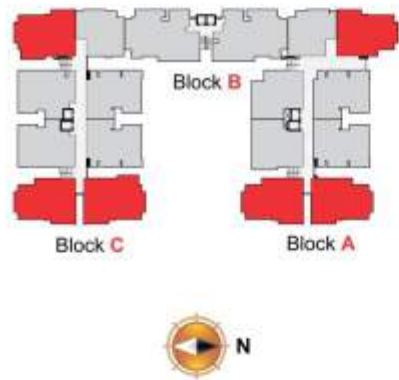

* Built up area is 20% less than Super Built up area.

Facilities at the CLUB HOUSE

- Club House • Badminton Court • Swimming Pool (along with kid's pool) • Modern GYM • Party Hall • Table Tennis • Billiards • Carom / Chess • Temple • Home Theater



FINEST OF INTERIOR SPECIFICATION

- Vitrified tile flooring.
- Wooden flooring in Master Bed Room.
- Soothing Distemper Paint.
- Split AC in all bed rooms.
- Aluminum windows.
- Tele Security / Intercom system.
- POP finish on walls and soothing distemper color paint.
- Designer Main Entrance Door.
- Electrical Modular switches and fittings of reputed brands.
- T. V. and telephone points in all rooms.
- Electrical points for exhaust fan, geyser and water purifier in kitchen.
- S. S. Sink with granite platform in kitchen.
- 100% Power Back up.**
- Bathroom sanitary fittings of reputed brands.
- 2Ft. Tiles above platform area in Kitchen.
- Anti Skid ceramic tiles on floor in bathrooms, Balcony and Kitchen.
- Designer ceramic tiles up to 7Ft height on walls in Bathrooms.
- Modular Kitchen.

**Terms and Conditions Apply

Type -1 (4 BHK)

S.B.U.A. 2422.29 sq.ft.
to 2446.83 sq.ft.

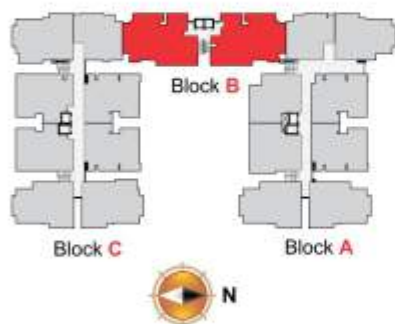

* Built up area is 20% less than Super Built up area.

THE FINEST OF FEATURES

Get pampered with the thoughtful assortment of all the world-class features and amenities served on a Royal platter, awaiting your patronage right at your doorstep. Amenities fit to be served to the kings. Beginning from comfort and continuing to luxury and ending at security. Everything, you would want to shower your loved ones with.

First time in Alwar **Fully Air-conditioned Bedrooms** with Modern Modular Kitchen

Location Map

(Map not to Scale)

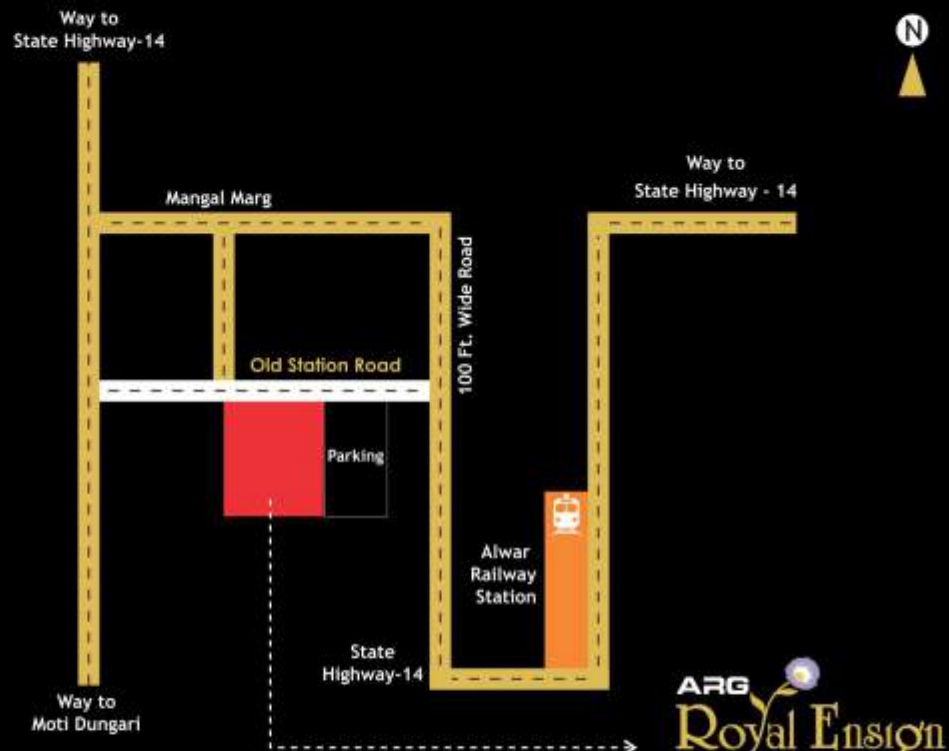

SITE ADDRESS :

Old Station Road, Dak Banglow (Nirvana Garden), Alwar - 301 001

ARG
Royal Ensign
Premium Luxury Apartments

BUILDERS & DEVELOPERS :



ARG
GROUP
ART OF MODERN CONSTRUCTION



ARG ROYAL ENSIGN DEVELOPERS PVT. LTD.

Corporate Office :

E - 52, Chitrangan Marg, C-Scheme, Jaipur-302 001

T : +91 141 4086677 • F : +91 141 4086666

M : +91 9314238914

E : sales@arggroupjaipur.com

W : www.arggroupjaipur.com

Alwar Site / Office Address :

Old Station Road, Dak Banglow

(Nirvana Garden), Alwar - 301 001

T : +91 144 2704168

M : +91 9314138915

ARG GROUP'S LANDMARK PROJECTS :

- Arg One, Tonk Road, Jaipur
- Arg Puram, Agra Road, Jaipur
- North Avenue, Sikar Road, Jaipur
- Divine Enclave, Ajmer Road, Jaipur
- ARG City, Jaipur Road, Ajmer
- Corporate Park, Gopal Bari, Jaipur
- City Mall, Jhalawar Road, Kota
- DD City Mall, Mlb Road, Gwalior
- The Metro, Rambagh Circle, Jaipur
- Arunodaya, Tilak Nagar, Jaipur
- Neelkanth Heights, Hawa Sadak, Jaipur
- Goverdhan Kripa, C-scheme, Jaipur
- Time Square, Vidhyadhar Nagar, Jaipur

ROYAL ENSIGN GROUP PROJECTS :

- Royal Ensign, Prithviraj Road, Jaipur
- City Plaza, Shastrinagar, Jaipur
- City Centre, Sansar Chand Road, Jaipur
- Golden Tulip, Shastrinagar, Jaipur
- Skit, Jagatpura, Jaipur
- 5 Nrd Nirwana, Nirwana, Block Suratgarh
- Hotel Nirwana Palace, Alwar
- Hotel Nirwana Palace, Jaipur

Architects :

m|a|architects

E : studio@maarchitects.in

Services Consultant :



Landscape Consultant :



Disclaimer : Promoters reserve the right to change any design, features and specification of the building without any prior notice and information. This brochure is for illustration purpose only and it cannot be in any way treated as a legal document. All information, specifications, plans, material and visual representations contained in the brochure, model & sample flat are subject to change from time to time by the promoters and / or the competent authorities and shall not form part of the offer or contract.